

RS675/677

O-RING MOUNTED BALANCED SEAL

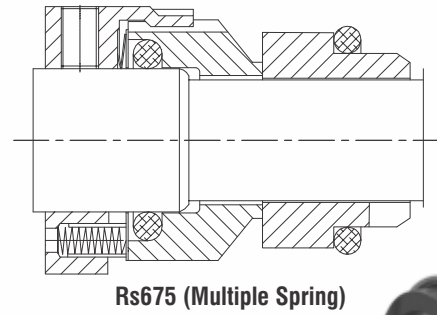
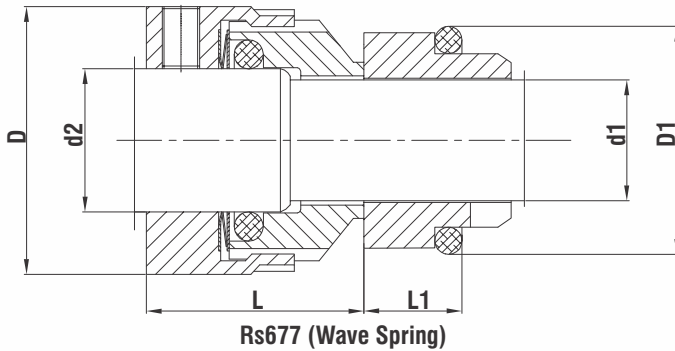

RS675/677				GS9/GS92	
d1	d2	D	L	D1	L1
14	18	33	32.5	25	10.0
16	20	35	32.5	27	10.0
18	22	37	33.5	33	11.5
20	24	39	33.5	35	11.5
22	26	41	33.5	37	11.5
24	28	43	36.0	39	11.5
25	30	45	36.0	40	11.5
28	33	48	38.5	43	11.5
30	35	50	38.5	45	11.5
32	38	55	38.5	48	11.5
33	38	55	38.5	48	11.5
35	40	57	38.5	50	11.5
38	43	60	38.5	56	14.0
40	45	62	38.5	58	14.0
43	48	65	38.5	61	14.0
45	50	67	38.5	63	14.0
48	53	70	38.5	66	14.0
50	55	72	42.5	70	15.0
53	58	79	42.5	73	15.0
55	60	81	42.5	75	15.0
58	63	84	47.5	78	15.0
60	65	86	47.5	80	15.0
63	68	89	47.5	83	15.0
65	70	91	47.5	85	15.0
70	75	99	52.0	92	18.0
75	80	104	52.0	97	18.0
80	85	109	51.8	105	18.2
85	90	114	56.8	110	18.2
90	95	119	56.8	115	18.2
95	100	124	57.8	120	17.2
100	105	129	57.8	125	17.2

FEATURES & BENEFITS:

- ▶ Single Seal
- ▶ Balanced
- ▶ Bi-Directional
- ▶ Non-welded continuous wave spring available per request
- ▶ Retainer with pumping screw available as Rs676

OPERATING LIMITS:

- ▶ $d_1 = 14 - 100 \text{ mm}$
(105 - 200 mm available per request)
- ▶ $p_1 = 2.4 \text{ Mpa}$
- ▶ $t = -35 - 160^\circ\text{C}$
- ▶ $V_0 = 20 \text{ m/s}$

STANDARD MATERIALS OF CONSTRUCTION:

- ▶ **Rotary Faces:**
 - ▶ Silicon Carbide, Alumina Ceramic, Carbon Graphite, Cr-Mo Steel
- ▶ **Stationary Seats:**
 - ▶ Silicon Carbide, Carbon Graphite
- ▶ **Spring Collars:**
 - ▶ AISI 304, 316
- ▶ **Secondary Seals:**
 - ▶ EPDM, FEP, FPM, FEPM

STATIONARY SEATS:

- ▶ Gs9 (standard), Gs92 (Carbon only), GS9S (Carbide face shrink fitted)
- ▶ Gs4 ▶ Gs6 ▶ Gs13