

# RSHDS

## HEAVY DUTY HIGH PRESSURE CARTRIDGE

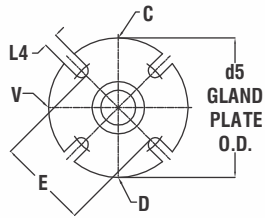

**Connections:-**  
**C - Circulation or Flush**  
**V - Vent**  
**D - Drain**

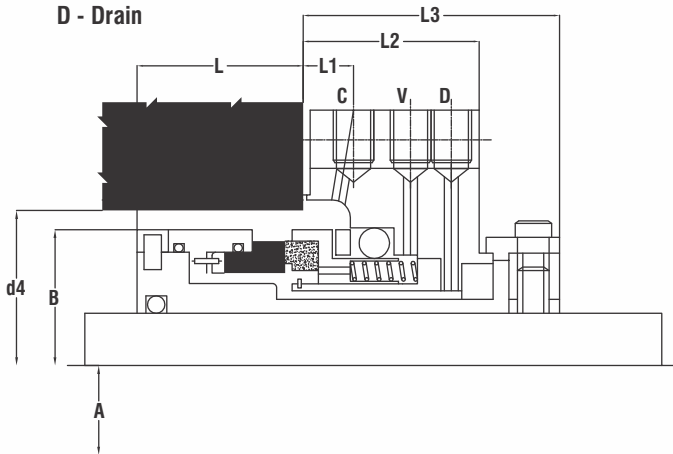

A	B	d4 MIN	d4 MAX	d5	E	L	L1	L2	L3	L4
0.500	1.811	1.929	2.244	4.133	2.637	1.338	0.590	1.519	2.047	0.452
0.750	2.062	2.181	2.372	4.330	2.755	1.338	0.590	1.519	2.047	0.452
0.875	2.185	2.303	2.498	4.527	2.875	1.338	0.590	1.519	2.047	0.452
1.000	2.311	2.429	2.625	4.645	2.992	1.338	0.590	1.519	2.047	0.452
1.125	2.437	2.555	2.750	4.901	3.107	1.338	0.590	1.519	2.047	0.452
1.250	2.562	2.692	2.818	5.039	3.228	1.338	0.590	1.519	2.047	0.452
1.375	2.688	2.807	3.000	5.250	3.548	1.338	0.590	1.519	2.047	0.452
1.500	2.811	2.929	3.055	5.433	3.622	1.338	0.590	1.519	2.047	0.531
1.625	2.937	3.055	3.181	5.629	3.779	1.338	0.590	1.519	2.047	0.531
1.750	3.062	3.181	3.750	6.500	4.368	1.397	0.590	1.519	2.047	0.531
1.875	3.188	3.307	3.875	6.500	4.153	1.397	0.590	1.519	2.047	0.531
2.000	3.311	3.429	3.779	6.692	4.251	1.397	0.590	1.519	2.047	0.531
2.125	3.437	3.555	4.000	7.250	4.622	1.456	0.590	1.519	2.149	0.688
2.250	3.562	3.681	4.212	7.519	4.763	1.456	0.590	1.519	2.149	0.688
2.375	3.688	3.807	4.448	7.716	4.921	1.456	0.590	1.519	2.149	0.688
2.500	3.818	3.944	5.000	8.250	5.496	1.456	0.590	1.519	2.149	0.688
2.625	4.153	4.279	4.750	8.000	5.121	1.456	0.590	1.519	2.149	0.688
3.000	4.685	4.811	5.125	8.250	5.621	1.456	0.590	1.519	2.149	0.688



### FEATURES & BENEFITS:

- ▶ Fits standard big bore pumps
- ▶ Heavy duty construction
- ▶ Can replace double seals in many applications
- ▶ Flush, Quench and Drain standard
- ▶ Guided Quench
- ▶ Large radial clearances to allow for shaft deflection and/or eccentric installations
- ▶ Floating carbon bushing
- ▶ Excellent in crystallizing liquid
- ▶ Large cross section dynamic "O" ring
- ▶ Shrunk in stationary face
- ▶ Non-clogging design

### OPERATING LIMITS:

- ▶ Temperature: From -40°F to 535°F
- ▶ 40°C to 280°C
- ▶ Pressure: Upto 365 PSI / 25 Bar

### STANDARD MATERIALS OF CONSTRUCTION:

- ▶ **Faces:**
  - ▶ Carbon / Silicon Carbide
  - ▶ Silicon Carbide / Silicon Carbide
  - ▶ Tungsten Carbide/ Silicon Carbide
- ▶ **Elastomers:**
  - ▶ Buna, Viton\*, PTFE, Neoprene, EPR, Kalrez\*, FEP, AFLAS\*
- ▶ **Metallurgy:**
  - ▶ 316 SS, Alloy 20, Hast B+C\*