

Rs157

SINGLE SPRING O-RING STYLE

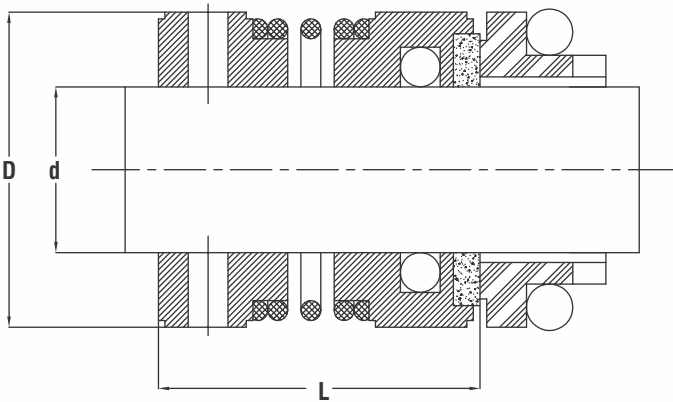

d (mm)	d (in)	D (mm)	D (in)	L (mm)	L (in)
16	0.625	29.0	1.142	32.5	1.280
18	0.750	32.5	1.280	32.5	1.280
20	-	34.5	*	35.5	*
22	0.875	35.0	1.378	35.5	1.398
25	1.000	38.1	1.500	39.0	1.535
28	1.125	42.9	1.689	41.0	1.614
30	-	45.5	*	41.0	*
32	1.250	47.0	1.850	44.0	1.732
33	-	49.0	*	44.0	*
35	1.375	50.0	1.969	47.0	1.850
38	1.500	53.0	2.087	47.0	1.850
40	-	55.0	*	47.0	*
42	1.625	55.5	2.185	47.0	1.850
43	-	55.5	*	47.0	*
45	1.750	60.0	2.362	47.0	1.850
48	1.875	62.0	2.441	55.0	2.165
50	-	66.0	*	58.5	*
-	2.000	66.7	2.620	58.5	2.303
55	2.125	71.0	2.795	60.0	2.362
58	2.250	73.0	2.874	60.0	2.362
60	2.375	77.0	3.031	63.0	2.480
63	2.500	79.4	3.126	63.0	2.480
65	-	82.0	*	66.0	*
68	2.625	82.6	3.252	66.0	2.598
70	2.750	87.0	3.425	66.0	2.598
73	2.875	90.0	3.543	71.0	2.795
75	-	91.5	*	71.0	*
-	3.000	95.3	3.752	77.5	3.051
80	3.125	99.5	3.917	77.5	3.051
-	3.250	101.6	4.000	77.5	3.051
85	3.375	105.5	4.154	77.5	3.051

d (mm)	d (in)	D (mm)	D (in)	L (mm)	L (in)
-	3.500	108.0	4.252	77.5	3.051
90	-	110.5	*	82.0	*
95	-	115.5	*	82.0	*
100	-	120.0	*	82.0	*
-	4.000	124.5	4.902	88.5	3.484

FEATURES & BENEFITS:

- ▶ Machined head is standard to withstand more rigorous conditions
- ▶ Uni-directional (dependent on shaft rotation)
- ▶ Rugged single spring minimizes clogging in stuffing box
- ▶ 316 SS Standard Material to withstand wider variety of aggressive fluids
- ▶ Inserted protected faces
- ▶ Multiple face & elastomer choices
- ▶ Set screw lock collar improve setting & drive reliability

OPERATING LIMITS:

- ▶ Pressure: to 200psi 13.8 Bar
- ▶ Temperature: -40°F to +400°F

STANDARD MATERIALS OF CONSTRUCTION:

- ▶ **Faces:**
 - ▶ Carbon Graphite (Resin Impregnated), Antimony Impregnated Carbon, Silicon Carbide, Tungsten Carbide
- ▶ **Elastomers:**
 - ▶ Buna, Viton®, Aflas®, Neoprene, EPDM
- ▶ **Metallurgy:**
 - ▶ 304, 316, Monel