

RS253/254

NON PUSHER PTFE BELLOW SEAL

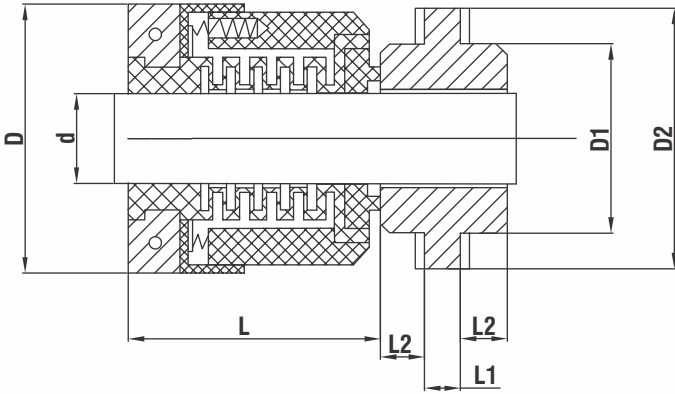

d	d (in)	Rs253		Rs254		Ts3			
		D	L	D	L	D1	D2	L1	L2
19	0.750	-	-	54	31	36.4	47	8.0	4.8
20	-	-	-	57	31	39.6	50	8.0	4.8
22	0.875	-	-	57	31	39.6	50	8.0	4.8
24	-	-	-	61	33	42.7	53	8.0	4.8
25	1.000	60	43.5	61	33	42.7	53	8.0	4.8
28	1.125	60	43.5	67	36	50.7	63	11.0	8.0
30	-	67	43.5	70	37	53.9	66	11.0	8.0
32	1.250	-	-	70	37	53.9	66	11.0	8.0
33	-	72	43.5	73	38	57.0	69	11.0	8.0
35	1.375	72	43.5	73	38	57.0	69	11.0	8.0
38	1.500	-	-	76	38	63.4	76	11.0	8.0
40	1.625	78	43.5	80	40	66.5	79	11.0	8.0
43	-	-	-	83	40	69.7	82	11.0	8.0
45	1.750	84	47.5	83	40	69.7	82	11.0	8.0
48	-	-	-	89	43	79.3	95	14.3	9.5
50	2.000	88	47.5	89	43	79.3	95	14.3	9.5
53	2.125	-	-	103	53	82.4	98	14.3	9.5
55	2.250	93	47.5	107	53	85.6	101	14.3	9.5
58	-	-	-	110	53	88.8	106	14.3	9.5
60	2.375	98	52.0	110	53	88.8	106	14.3	9.5
63	2.500	-	-	113	53	91.9	108	14.3	9.5
65	2.625	103	52.0	116	53	95.1	111	14.3	9.5
68	-	-	-	118	38	98.3	114	14.3	9.5
70	2.750	-	-	118	53	98.3	114	14.3	9.5
75	3.000	-	-	126	53	103.1	119	14.3	9.5

FEATURES & BENEFITS:

- ▶ Single Seal
- ▶ Multiple Springs
- ▶ Bi-Directional
- ▶ PTFE bellows
- ▶ Externally mounted
- ▶ Replaceable Seal Face

OPERATING LIMITS:

- ▶ $d_1 = 19 - 75 \text{ mm}, 0.750 - 3.000''$
- ▶ $p_1 = 1.0 \text{ Mpa}$
- ▶ $t = -35 - 120^\circ\text{C}$
- ▶ $V_g = 15 \text{ m/s}$

STANDARD MATERIALS OF CONSTRUCTION:

- ▶ **Faces:**
 - ▶ Carbon Graphite, Filled PTFE, Silicon Carbide
- ▶ **Stationary Seats:**
 - ▶ Alumina Ceramic, Silicon Carbide
- ▶ **Spring Clamps:**
 - ▶ AISI 304, 316
- ▶ **Secondary Bellow Seals:**
 - ▶ PTFE
- ▶ **Housing:**
 - ▶ Filled PTFE

STATIONARY SEATS:

- ▶ **Clamp Seats:**
 - ▶ LS1, TS1, TS2, TS3 (standard), TS4